

PN 8/3225

NO

CS

HSS



BUČOVICE TOOLS

Závitové kruhové čelisti
Circular dies
Schneideisen
Плашки

M

Metrický závit
 Standard metric thread
 Metrische Regelgewinde
 Метрическая резьба

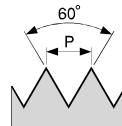
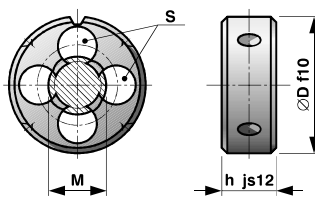

1,5P

	P	D	h	S		code NO/CS	code HSS
M 3	0,5	25	9	3	3,0	230 030	260 030
M 4	0,7	25	9	3	4,0	230 040	260 040
M 5	0,8	25	9	4	5,0	230 050	260 050
M 6	1	25	9	4	6,0	230 060	260 060
M 7	1	25	9	4	7,0	230 070	260 070
M 8	1,25	25	9	4	8,0	230 080	260 080
M 8	1	25	9	4	8,0	230 081	260 081
M 10	1,5	25	9	5	10,0	230 100	260 100
M 10	1	25	9	5	10,0	230 101	260 101
M 12	1,75	25	9	5	12,0	230 120	260 120
M 12	1,5	25	9	5	12,0	230 121	260 121
M 12	1	25	9	5	12,0	230 122	260 122

*Materiál: NO; HSS
 Provedení: závit lapovaný
 Závit: pravý
 Licování: 6g*

*Material: CS; HSS
 Execution: lapped thread
 Thread: right-hand
 Tolerance: 6g*

*Werkstoff: WS; HSS
 Ausführung: geläpftes Gewinde
 Gewinde: rechts
 Toleranz: 6g*

*Material: NO; HSS
 Изготовлено: резьба
 Резьба: правая
 Подгонка: 6g*

PN 8/3213

NO

CS

HSS



BUČOVICE TOOLS

Závitové kruhové čelisti
Circular dies
Schneideisen
Плашки

P

Pancéřový závit
 Steel conduit thread
 Stahlpanzerrohr-Gewinde
 Панцирная резьба

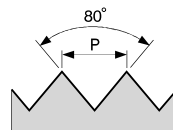
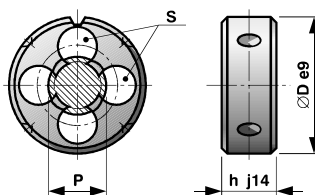

1,5P

	z/1"	P	D	h	S		code NO/CS	code HSS
P 7	20	1,270	38	10	4	12,5	213 070	243 070
P 9	18	1,411	45	14	5	15,2	213 090	243 090
P 11	18	1,411	45	14	5	18,6	213 110	243 110
P 13,5	18	1,411	45	14	6	20,4	213 135	243 135
P 16	18	1,411	55	16	5	22,5	213 160	243 160
P 21	16	1,588	55	16	7	28,3	213 210	243 210
P 29	16	1,588	75	20	7	37	213 290	243 290
P 36	16	1,588	90	22	8	47	213 360	243 360
P 42	16	1,588	90	22	10	54	213 420	243 420
P 48	16	1,588	100	25	10	59,3	213 480	243 480

*Materiál: NO;
 HSS, HSSE - dle požadavku
 Provedení: standardní
 Závit: pravý*

*Material: CS;
 HSS, HSSE - on request
 Execution: standard
 Thread: right-hand*

*Werkstoff: WS;
 HSS, HSSE - nach dem
 Anspruch
 Ausführung: normal
 Gewinde: rechts*

*Material: NO;
 HSS, HSSE - по заказу
 Изготовлено: стандартно
 Резьба: правая*

